

**Note:**

1. The installation instructions may be slightly different from the actual operation. If there is any difference, please contact us according to the actual situation or.
2. Warning: do not disassemble any parts by yourself. Any improper operation is not within the scope of warranty.
3. Before installing the product, please turn off the vehicle power supply and cut off the negative pole of the battery on the front cover.
4. Before installing the product, watch the installation video and instructions carefully.

**Installation Tutorial Video**



**Aftersale Service**  
**+86 156 2278 2181**

## Installation Manual

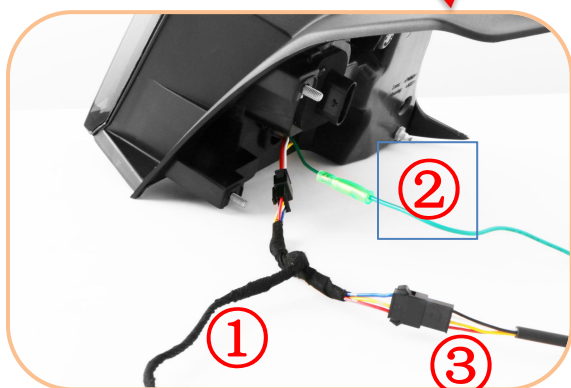
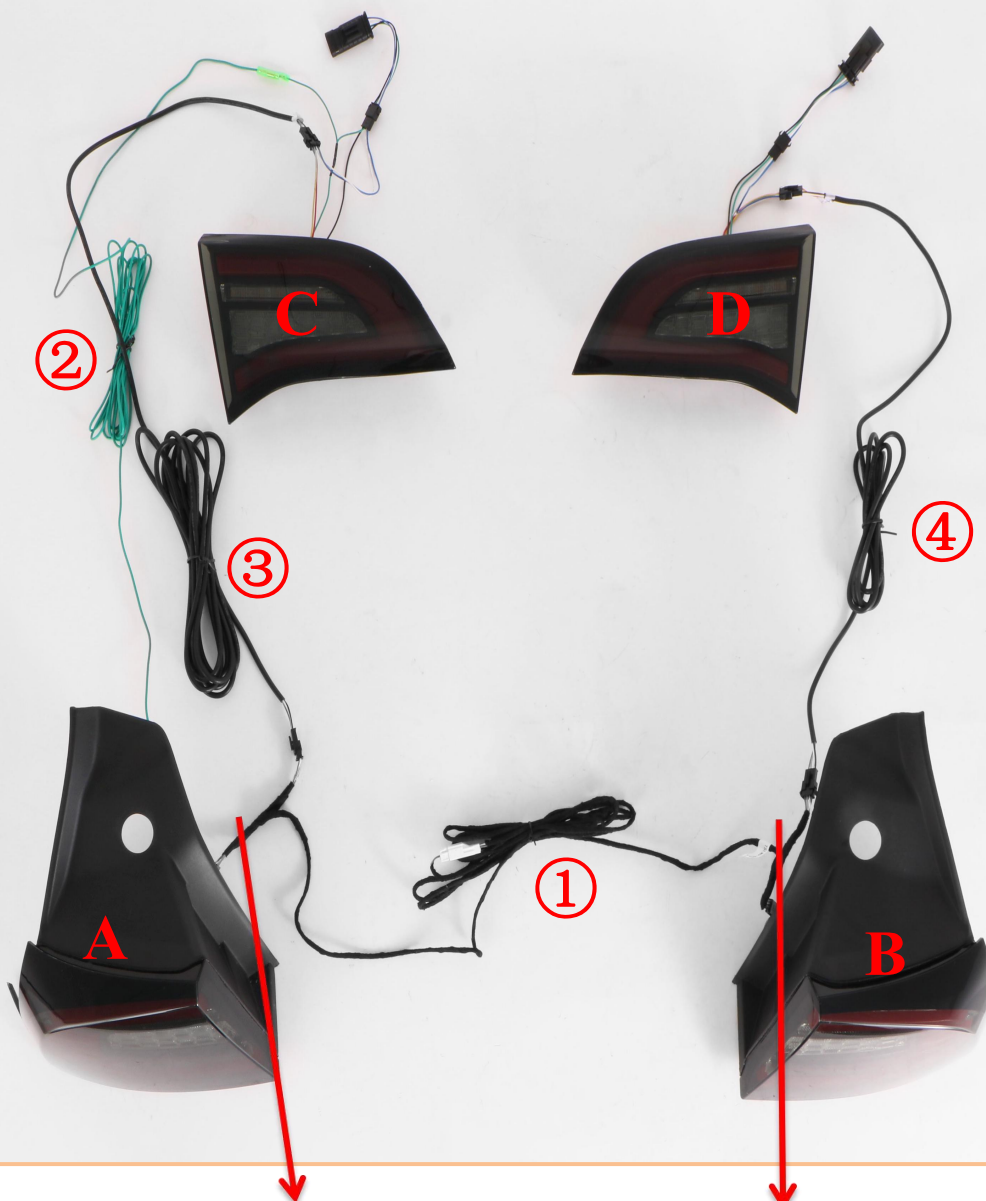

left lower tail light A  
wiring diagram



right lower tail light B  
wiring diagram



1. Remove the trunk interior trim panel



2. Remove trim cover

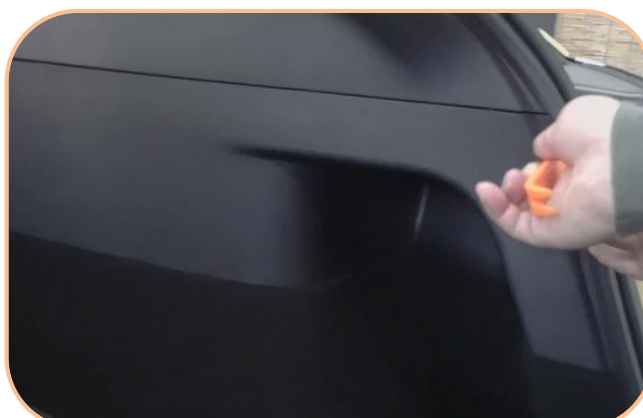

3. Pry the trim panel cover on the right (the same operation on the left)



4. Pry off the rear tail light cover, unscrew two nuts on the interior trim panel, and then remove the tail light (the same operation on the left)



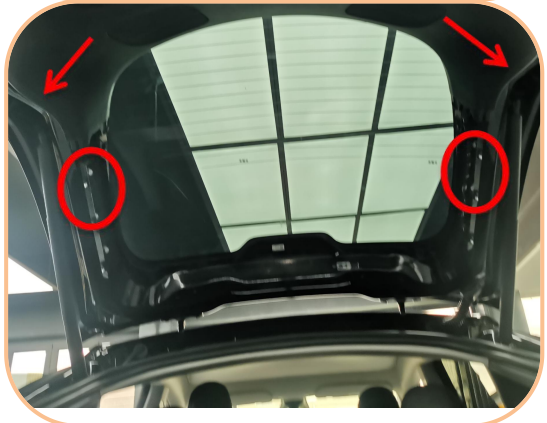

5. First remove the upper cover; remove the left and right buckles, and then remove the trim panel cover



6. Unscrew the nut of the upper tail light, pry out the upper tail lamp and replace it with eagle eye taillight -C.D)



7. According to the indicates in the picture, thread the wire ② ③ ④ through the rubber pipe of the original vehicle and lead it to the upper tailgate







8.Route the wires to the upper tailgate and insert it at the corresponding position according to the indicates in the picture

